

SECOND FLOOR PLAN

375 YORK AVENUE, WINNIPEG, MANITOBA, CANADA R3C 3J3
 PHONE: (204) 956-1720 FAX: (204) 943-0310
 TOLLFREE: 1-800-565-7776 EMAIL: info@wcc.mb.ca
www.wcc.mb.ca

■ indicates load-bearing pillar
 - - - - - indicates movable wall panels

NOTE:
Fire Exits must not be blocked at any time.

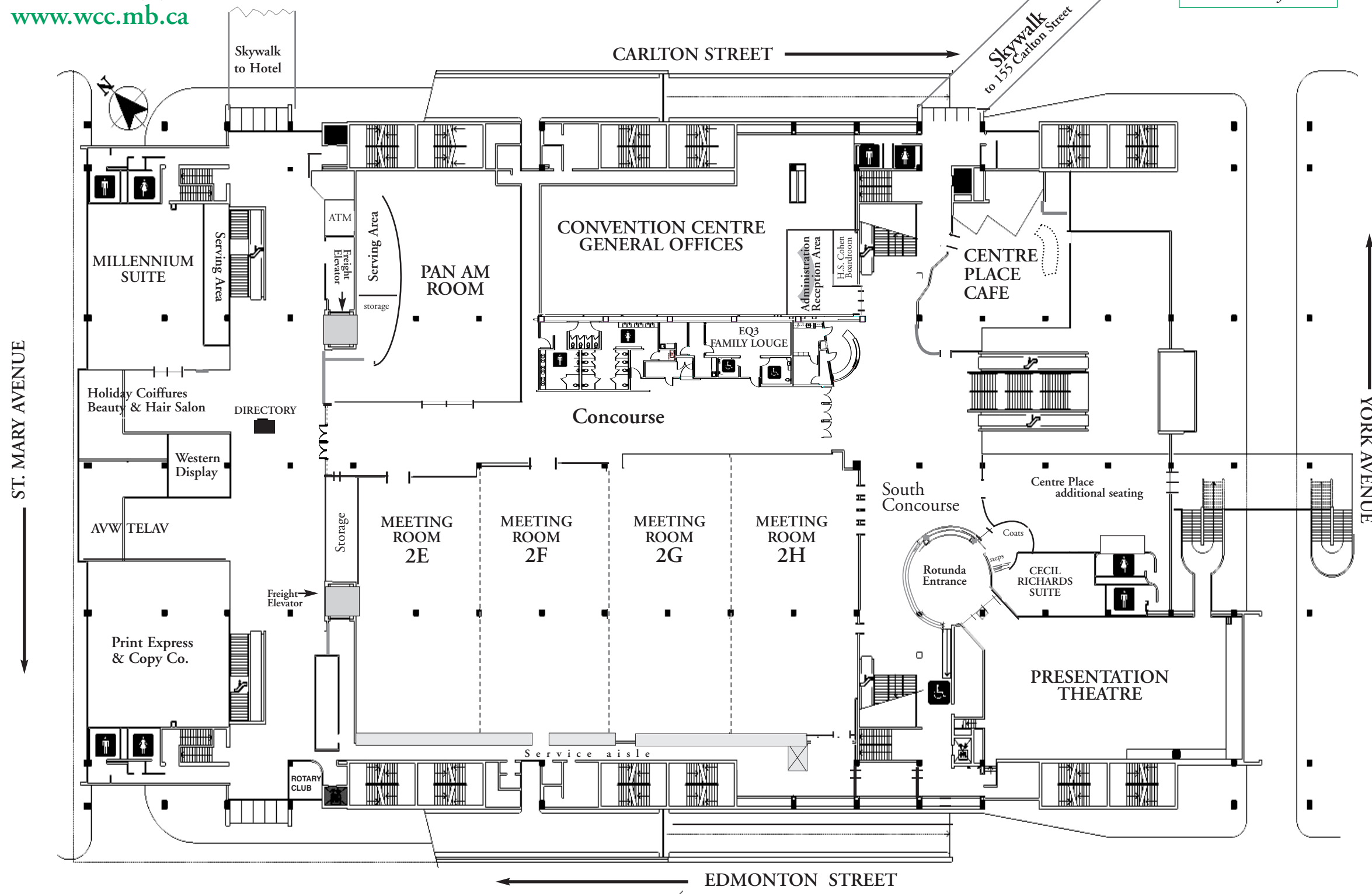

ROOM	ft ²	M ²	Theatre (number of persons/room shown)	Classroom	Banquet
------	-----------------	----------------	---	-----------	---------

Room 2E	4,552	423	440	200	300
Room 2F	4,792	446	470	210	330
Room 2G	5,017	466	480	220	340
Room 2H	4,880	454	470	210	330

Combined 2E-2F-2G-2H					
	19,241	1,790	2,100	1,100	1,300
<i>ceiling height for above rooms is 12.5 ft.</i>					

Presentation Theatre					
	5,100	474	n/a	300	n/a
<i>ceiling height varies (floor is tiered)</i>					
Fully equipped with stage, movie theatre screen, tiered comfort seating, privacy desks & control room.					
Laptop connections at all seats with high speed internet.					

Millennium Suite					
	2,650	247	270	110	150
<i>ceiling height 9 ft.</i>					

Pan Am Room					
	4,150	386	500	225	270
<i>ceiling height 8 - 10 ft.</i>					

Cecil Richards Suite					
Boardroom set-up for up to 18 people at the table, full audio/visual connections, private washrooms and coat check/registration area					

ROOM PLANNING NOTE:
 Room accommodations show optimum numbers and may change according to type of staging, podiums, A/V equipment and displays used. Sizes shown on this plan are approximate and may vary.

PLAN ON US!
 Get the complete Meeting Planners interactive connection (MeetingMatrix) through our internet site
www.wcc.mb.ca